

# **10410 - HALDEX MULTI ADJUSTABLE AUTOMATIC SLACK ADJUSTER PULLER**

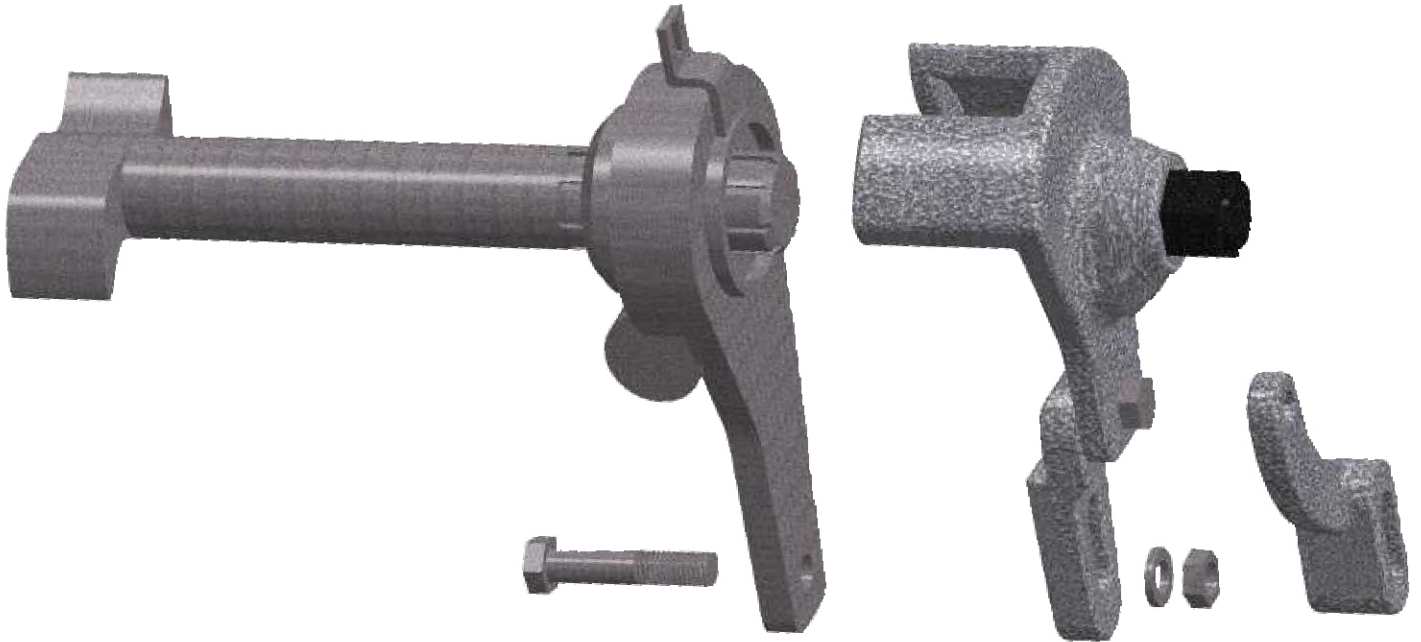

## **OPERATING INSTRUCTIONS**

- 1) Remove Clevis Pin and Clevis from the end of the Slack Adjuster with the Tiger 10501 (TG393) Brake Clevis Pin Press.
- 2) Select proper arm and attach to puller main body with  $\frac{1}{2}$ " X 1" bolt supplied. Do not tighten at this time. Note the straight arm is for older style Haldex slacks as shown above, and the bent arm is for newer angled and / or offset Haldex Slack Adjusters.
- 3) With forcing screw fully backed out, slip the puller onto the Slack Adjuster.
- 4) Insert  $\frac{1}{2}$ " X 2  $\frac{1}{2}$ " bolt through clevis pin hole and puller arm slot. Secure with washer and nut by hand.
- 5) Tighten  $\frac{1}{2}$ " X 1" and  $\frac{1}{2}$ " X 2  $\frac{1}{2}$ " to securely mount puller to Slack Adjuster.
- 6) Turn the forcing screw with a hand or a  $\frac{1}{2}$ " impact wrench.
- 7) Slack Adjuster will drop off when free.

**Threads must be clean and well lubricated at all times.**

**Do not use over a  $\frac{1}{2}$  inch impact wrench - doing so will void warranty.**

***TIGER TOOL***  
***International Incorporated***

**1-800-661-4661  
or (604) 855-1133**